

CERTIFIED RECORD OF LAND CORNER MONUMENTATION

History of original corner establishment: *

The original corner was set in 1881 by Robb and Gradon under Contract No. 383, dated March 26, 1881.

The original notes state:

- N89°46'W on true line on N boundary of Sec 4
- 80.00 Set post for cor to secs 4,5,32 & 33 from which
 - A pine 36 ins dia bears N 65° W 82 lks dist
 - A pine 20 ins dia bears N 80° E 131 lks dist
 - A pine 34 ins dia bears S 55° E 143 lks dist
 - A pine 36 ins dia bears S 5° W 68 lks dist

DIAGRAM
 T9S R32E
 S32|S33
 ----+----
 S5|S4
 T10S

Description of corner evidence found:

Found no evidence of the original post.
 A 40" P. Pine bears N 64° W, 54.4 ft to face (N 65° W, 82 lks), scribed S32 and a chaining notch in an open face.
 A 21" P.Pine snag bears N 84½° E, 86.3 ft to face (N 80° E, 131 lks), scribed T9SR32E in an open face.
 The roothole of a Pine, down and dead, bears S 54½° E, 94.3 ft (S 55° E, 143 lks), face and chaining notch visible on trunk.
 A 39" P.Pine bears S 3½° W, 45.3 ft to face (S 5° W, 68 lks), scribed R32ES5 in an opened face. The face is on the NE side of this tree.

Description of monument and accessories I establish to perpetuate the original location of this corner:

I reestablish the corner position at the mean record distance from the NE, NW, and SW bearing trees. Set a 2½x28" aluminum monument 21" in the ground in a small mound of stone.

I establish new bearing trees:

- An 11" P.Pine bears S 64½° W, 36.6 ft, scribed T10SR32ES5BT.
- A 10" Fir bears N 8-3/4° W, 62.4 ft, scribed T9SR32ES31BT.
- A 12" P.Pine bears N 38½° E, 15.0 ft, scribed T9SR32ES32BT.
- A 12" Fir bears S 43½° E, 21.0 ft, scribed T10SR32ES4BT.

T9S R32E
 S32|S33
 ----+----
 S5|S4
 T10S
 PLS1918
 1988

New BTs have 3/4" brass washers marked PLS1918 attached to the BT blaze, faces and bands painted with red tree marking paint, and BT tags and Attention or Land Survey Monument signs. A steel fence post with Attention or Land Survey Monument sign is driven approximately 3-5 feet from the corner.

Sun Cadastral Survey, Cont No. 53-04H1-7-4011
 Field Book: 4-40 & 6-37
 Work accomplished: 9/1/88
 Witnesses: Tyler Parsons, Sharon Parsons
 Louise Parsons, Douglas Parsons
 Job No.: 87221

PARSONS SURVEYING
 1915 S.E. Stone Street
 Corvallis, OR 97333
 (503) 752-7515

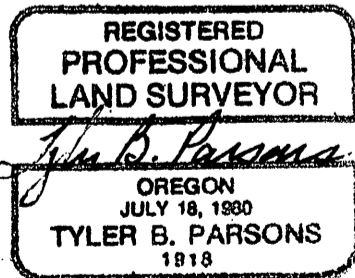

Office of COUNTY SURVEYOR County of GRANT
 State of OREGON, I hereby certify that the within instrument was filed in this office
 for record on the 27th day of Feb, 1989

Robert D. Sargent by _____
 (COUNTY OFFICIAL) (DEPUTY)